

No: 9 Aug/Sept 1988

# Stewart Island News

Box 65 Halfmoon Bay STEWART ISLAND New Zealand

## Alan Wilson - 1928 to 1988

Price: \$1.00

Subscription: \$15.00

[Posted in NZ]

### CONTENTS

#### Page

Past News	2
Alan Wilson	2
Power to the People	4
Sewerage Scheming	6
Council Comments	7
Roadside Weeds	8
Garden Circle	9
Arts & Crafts Co-op	9
Bridal Fashions	10
Fire Brigade	12
Promotion Assn	12
The Salmon Pen	13
Shearwater Inn	14
Folk Concert	15
Ross's Rumblings	15
Southern Airlines	16
Charter Chatter	16
From the SIN-BIN	17



This Issue of Stewart Island News is dedicated to the  
memory of Alan Wilson, who died at his home July 26 1988  
"Thank You For All You Did"

[Regd Publication]

ISSN: 0113-4477

Office: Rakiura Museum  
STEWART ISLAND  
New Zealand

Stewart Island News is produced in Oban, and aims to foster  
interest in the natural and past and present history of this,  
New Zealand's southernmost community.

Production Team: Sam Sampson, Margaret Hopkins,  
Barry Rhodes, Kathy Walker

**Past Island News**

Compiled by Peggy Wilson

LOCALS STUFFED

News = Southland Daily News

Times = Southland Times



### 10 Years Ago

The Secret - This fine old lady undergoing further repairs at Halfmoon Bay, has been sailing in Stewart Island waters for more than 80 years, and is still going strong. The *Secret* was built at Horseshoe Bay, Stewart Island, by Mr Ned Johnson great-grandfather of present owner Mr I Johnson. Some of the family are sure of the year of her launching, but put it around 1898. Kauri-planked, the 11-metre *Secret* now only carries auxiliary sail. A Gardiner engine was installed about 15 years ago. However, there are plans to eventually revert the boat to her original rig."

Times- 15 Sep 1978

Two new diesel oil tanks have been transported to Stewart Island on the ferry *Vairua*. The tanks which will be installed on a concrete pad at the end of Wharf St in November, will supplement the Island's fuel storage."

Times- 20 Sep 1978

### 5 Years Ago

"Marine farming at Stewart Island will be permitted only in Big Glory Bay, the Government has confirmed, and farms are expected to be in operation by the end of the year."

Times- 27 Aug 1983

"Southern Air is to finally open up its Ryans Creek airstrip to other users, after having refused landing rights to private pilots since the strip was built in 1977."

Times- 27 Sep 1983

### To Our Stewart Island Community

## Alan Hugh Wilson

On July 26th 1988 Alan passed away. We, his wife Peggy, His children Gordon, Barbara, Ian and our families would like to pass on our appreciation of the many messages of sympathy expressed to us at this sad time. Alan mentioned many times during his illness what marvellous people Stewart Islanders are, and we could not agree more.

Thank you to all those people who came to see Alan during his illness and to all those who expressed sympathy and concern after his death, to the large number of people who attended both services and the interment of ashes at his home and to those who sent cards, letters, flowers, baked and phoned.

To all Stewart Islanders, words can't convey our gratitude to you, your acts of kindness were a tribute to one who meant so much to all of us.

Alan was a special husband, Dad and Grandad and we all will miss him very much. Please accept this as a personal acknowledgement.

Thank you all

Peggy Wilson & Family

## Memorial Plaque

Stewart Island Council Council have resolved to have a plaque made to commemorate Alan Wilson's service to the community. In keeping with his dedicated work maintaining generators, this is to be affixed to the new Power House, and will be unveiled by Peggy Wilson at the Official Opening on Sat 10th September.

## Alan Wilson

The Stewart Island community lost a good friend, diligent tradesman and family man with the recent death of Alan Wilson. For over a decade the Island has relied on Alan and his workshop truck to maintain the diesel engines which power the fishing fleet and up until the past few weeks, the electrical supplies for industry and household.

Born in 1928, Alan's early years were spent living at Awarua Plains and Woodend, as the youngest of a farming family. These were Depression times when the Awarua Plain, much of which was swampland, was seriously overrun with rabbits. In those days, Alan used to help on the run, mustering sheep on the land where the Tiwai smelter is now sited, as well as helping to keep up the supply for the rabbit factory at Bluff.

Alan attended Tisbury School and then furthered his education at Southland Technical College, after which he became apprenticed to Andrews & Beavan as a diesel mechanic in 1944. This trade was to last 44 years, which is in itself a most remarkable achievement. His trademark was renowned in his honesty and conscientious diligence applied to all aspects of his work.

His strong association with Stewart Island began when he met Peggy Jensen in 1946, and they were married in 1951. For many years they often came to the Island to visit Peggy's family and home at Harrolds Bay.

After 11 years with Andrews & Beavan, Alan then spent two years working for H E Melhops, where much of his time was spent working on many of the Stewart Island fishing boats. The next 16 years were spent as Foreman of the Southland County workshop, where his engineering skills were called to play on a wide range of equipment.

Cycling regularly from his Awarua home to school, college and work helped make Alan an extremely fit person. This energy was first evident on the school rugby field and he was soon winger for the Collegiate Rugby Club. Alan's commitment to the sport was not confined to playing, as he later founded the Southern Club at Woodend, serving as President and also coaching the players.

Rugby was not his only sporting interest, as Alan was a very keen table tennis player and also President of the Woodend Table

Tennis Club. His coaching abilities helped many young players, a number of whom excelled at National Championship level.

Another mainland community activity was Alan's involvement as a member of the Awarua Plains Domain Board, which incorporated both land management and functions at the Woodend Hall, whose social dances were renowned.

Long and ever strengthening ties finally resulted in a permanent move to Stewart Island in 1973. Alan took the opportunity to join in partnership with Stewart Island Welding Co, manufacturing crayfish pots, servicing diesel generators, car repairs, pot haulers and other engineering work.

In 1978 Alan continued this line of work independently and the mobile workshop of *Alan Wilson Motor Engineer* became an established sight on Stewart Island's roads and byways. In this capacity his work, often till late in the evening, kept the generating plants of the SI Fishermen's Co-operative, the slipway, other businesses and households functioning.

Alan's engineering talents were applied to general marine engineering in addition to maintaining boat motors, but he is also well remembered by many older residents for the work he did on household appliances, generators and vehicles, per favour and not as business.

A staunch foundation member of the Stewart Island Promotion Assn, he was keen in promoting all aspects of the Island. A major retirement project was to have been the continuation of restoration work on Ye Traveller's Rest, an 1870's boarding house on the Wilson property. Also to Alan and Peggy's credit, after many years of effort, the stone house of Lewis Acker [also sited on their land] has now had the stonework and re-roofing completed by the Historic Places Trust, though it is not as yet as complete as Alan had envisaged.

Alan's dedication to the community was only exceeded by his commitment to his wife Peggy and their children. He was an especially proud and devoted grandfather to his four grandsons and one granddaughter. His elder son Gordon and family live in Waimate, and his daughter Barbara and younger son Ian and their families live on Stewart Island.

- Beryl Wilcox

If You Need a Set of Clothes,  
Whether it's Jackets or Jocks,  
Or to Cover Your Toes,  
Just Give Us a Call  
And We'll Post Them Quick,  
A Good Selection So You Can Pick  
Something Special From:

**MCKENZIE**  
MENSWEAR

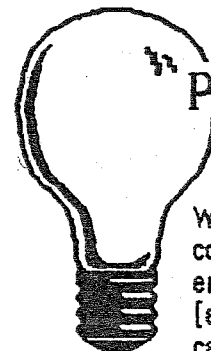

## Power House Opening

Sat 10th September

With all bar a few permanent homes now connected to the SIESA power supply, and enjoying cheap, reliable 24 hour power [apart from one unscheduled power cut caused by an un-programmed computer failing to cut in fuel to one generator], we are all starting to take the new life style for granted. The odd private generator still heard pattering away in the evenings just emphasizes how much we've become a "Quiet Village" at night.

Those who haven't yet heard the communal generators in operation will have a chance on Sat 10 September when the Official Power House Opening takes place. You'll actually listen to the electric motors in the cooling towers, as they make more noise than the exhausts from the Caterpillar diesels.

The opening ceremony will be held at the Power House at 1:30PM, and will be followed at 3:00PM by afternoon tea at the County Hall. Although only a few of the Electrix team are left here now, the Linemen will be turning on a Hangi for the locals at around 4:30PM - thanks for the nice gesture boys!

The Consumer Advisory Officer and the Electrical Supply & Training Officer from SEPS will be available at the County Hall from 10AM to 3PM on the Saturday, so this is the chance to make the most of their knowledge and expertise if you have any questions or problems.

SIESA have organised a Poster Competition and have prepared an Electrical Knowledge Questionnaire for pupils of Halfmoon Bay School. Entries for these are to be handed in to the County Office for judging by Fri 9 September.

There is also to be a competition for the oldest electrical appliance or item handed in with details of its use and manufacture to the County Office before 9:30AM on Sat 10 Sep. There are bound to be all sorts of geriatric goodies lurking in basements and pot sheds, so drag them out. All in all, it promises to be quite a festive day

- Sam

10:30 AM SEPS Officers at Hall

1:30 PM Official Opening of Power House

3:00 PM Afternoon Tea at Hall

4:30 PM Hangi

## What is a Lineman?

Between the enthusiasm of youth, and the disillusionment of retirement,  
There is an unusual creature called a Lineman.  
They come in assorted heights, girths, shapes  
And degrees of sobriety.  
They can be found anywhere, in tents, trucks,  
Up poles and towers [rarely] down manholes,  
And in debt.

Bookies love them, technicians tolerate them.  
Publicans rely on them, and  
Workers compensation protects them.  
A Lineman is an optimist with a tip for the 2.30.  
A superman in a 3 ton truck.  
An astronaut on the top of a pole or tower,  
And a cave explorer in a cablewell.  
He has the cunning of a very old fox,  
The generosity of a spendthrift,  
The imagination of Banjo Paterson,  
The thirst of the Sahara Desert and  
The elusiveness of the Scarlet Pimpernel.  
He likes overtime, beer, talking, more beer,  
Public Holidays [and Houses] and above all -  
An understanding Line Foreman!  
He hates cadgers, boss's men, upstart technicians,  
Paper work and bill collectors.

No other man can cram into a tool box  
Six rabbit traps, a fishing rod, a transistor radio,  
Six cans of beer, a copy of the Sporting Globe,  
And sometimes tools.

He gets more fun than anyone out of the races,  
Smoking and putting one over.  
No one else could exist on his salary,  
Yet remain so cheerful.

A Lineman is a magical creature,  
seldom appreciated but  
Indispensable in the time of trouble.

You can lock him out of the Exclusive Club, but  
You can't keep him out of your circle of friends.  
He's a talkative, troublesome, argumentative,  
timewasting bundle of fun.

But, when the storm breaks,  
The lines are blown down, the cablewell flooded,  
He can reassure you with seven magic words  
"We'll Soon Have Them Working Again Boss" -

Collected from various sources by :-  
**John Warren**

Here's hoping that culinary skills are  
something linemen can add to the list of virtues  
and vices that John has collected!  
We'll find out at the hangi I guess

With the reticulation of the Island being nearly completed and the first power accounts now received, the Authority is pleased with the prompt payment by consumers. Some 215 of the 320 consumers have been connected and it would indicate that not many will be left by the estimated contract completion date of 15 Sep.

To date the total load has been supplied by one 200 KW generator, with an average daily peak load of 150 KW, selling some 2,000 units daily.

## Electrical Inspections

These have indicated a reasonable standard of wiring, however a more detailed inspection is still to follow, when all lighting and power points will be counted. These details are required by Regulations and must be made available to Insurance Companies in case of fire, etc. Please ensure you apply for an electrical permit for any additions or alterations to your electrical system.

Generator sheds should have any surplus fuel removed, and be cleaned out if main supply is connected within. Keep access to your main indoor fuse panel clear at all times. Twenty four hour power has a greater stress on your electrical wiring and appliances. Special attention should be given to ensuring that appliances such as electric blankets are turned off when not actually in use.

## Payment of Power Accounts

If you are leaving the Island at meter reading times [usually the 1st and 2nd of each month] and are concerned about the payment of your account to prevent disconnection, please call at the County office, where arrangements can be made. Failure to pay your power account by the due date will result in disconnection unless prior arrangements have been made.

## Official Opening of Power House

Everyone is invited to attend the Opening Ceremony, after which the Power House will be open for public inspection. Afternoon tea will be served at the County Hall, followed by a hangi. The SEPS Community Advisory Officer and the Educational, Safety & Training Officer will have static displays on show, and be available to answer any queries.

- **Harry Slingsby**  
Secretary  
SIESA

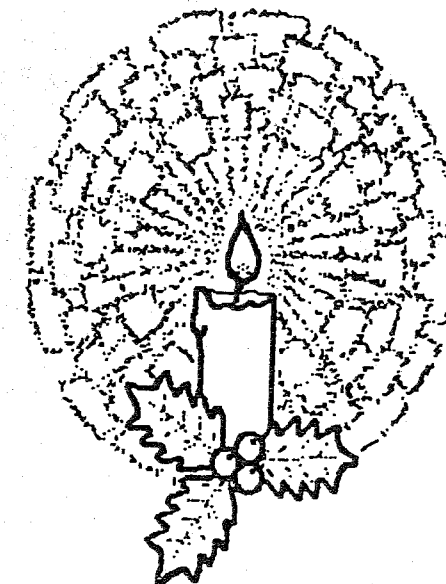

A lot has happened in the world of power and periodicals on Stewart Island since I played round with this candle illustration to produce the "Power Candle" in SIN No 3. That candle is finally guttering out. Remember the irony of not being able to get candles for love nor money just before the Power Scheme was cut in?

I guess we'll have to dig them out occasionally when something goes wrong - but generally, from now on, they should only be Xmas and Birthday decorations. Great stuff, eh!

- Sam

## Basin Award #13

### Wayne Frew

With less diesel tanks to fill, "Jack" Frew has taken up a new trade of chimney-sweep. We trust he isn't aiming to create a self-sustaining business by selling us a lower grade coal that produces more ashes and soot!

Jack set off for his first gainful employment in this unaccustomed role armed with a new set of brushes and an old vacuum cleaner [ex the South Sea Hotel so it's a real sucker] and a ladder.

At an undisclosed destination, he climbed the ladder and set about refurbishing the flue. The chimney was unused to such amorous advances, and in trying to avoid Jack's clutches flue fell to the ground, followed by the sweep and his ladder.

Always one for finding the most ergonomic and efficient method of doing a job, Jack stood amidst the pile of rubble and proceeded to clean the steel flue liner in the horizontal position.

**Nominated:** Anne Pullen  
**Seconded:** Ann's Insurance Co.

## Raising of Loan Finance

### Stewart Island County Council - NOTICE OF SPECIAL ORDER

Notice is hereby given that at a Special Meeting on 31 August 1988, the Stewart Island County Council resolved by way of Special Order, to raise the Stewart Island County Council Sewerage Scheme Establishment Loan of \$125,000 for the purpose of establishing a Sewerage Scheme in the Oban Urban Drainage Area on Stewart Island. The Council will be submitted for confirmation at the meeting of the Stewart Island County Council to be held on Wednesday 21 September 1988 in the Council Chambers, Ayr Street, Halfmoon Bay, Stewart Island.

#### The Council resolved as follows:

THAT in pursuance and exercise of the powers vested and conferred upon it by the Local Government Act 1974 and the Local Authorities Loan Act 1965, the Stewart Island County Council HEREBY RESOLVES this 31 day of August 1988 by way of Special Order as follows:

- 1 THAT the Council proceeds to raise the sum of One Hundred and Twentyfive Thousand Dollars [\$125,000] for the purpose of establishing the Stewart Island County Council Sewerage Reticulation Scheme in the Oban Urban Drainage Area.
- 2 THAT the said loan shall be known as the *Stewart Island County Council Sewerage Scheme Establishment Loan 1988* and that copies of the Special Order shall be deposited at the offices of the Council in Halfmoon Bay and open for inspection by the public during normal office hours.
- 3 THAT the security for the said Loan shall be a Special Rate of 5.850 cents in the dollar on the rateable value of all the vacant property within the Oban Urban Drainage Area, vacant sections being half rated.

Notice is hereby further given that a poll of electors is required to be undertaken if not less than 15% of those electors so demand in writing under their hands delivered by hand or sent by post to the office of the Council not later than 9 AM on the day fixed for confirmation of the

resolution to raise the loan. Every elector who signs the demand shall state their name and address with sufficient particulars to enable the person to be identified as an elector.

**Note:** Council having resolved to finance this scheme by means of Capital Contribution pursuant to Section 164C of the Local Government Act 1974, and a large number of electors in the Oban Urban Drainage Area having agreed to make Capital Contributions it could be noted that:

#### Electors making Capital Contributions Will NOT be Rated for Loan Finance

In the event of tenders greatly exceeding the latest estimates and this Loan proposal, the question of whether the Scheme should proceed will be referred back to the electors.

Dated at Halfmoon Bay this 31 day of August 1988

H G Slingsby  
County Clerk

### Further Comment

The public notice printed above, was inserted in the Southland Times on Sat 3 September 1988, and states Council's position as regards raising finance for the sewerage scheme.

Councillors viewed the high Special Rate of 5.850 cents in the dollar to be levied on those who do not make a Capital Contribution to the Sewerage Scheme with alarm. The reason for this high rate has been brought about by the large number of ratepayers, approximately 71, who opted not to make the capital contribution of \$1,905.

Many of these people may actually intend to make a capital contribution once the scheme gets underway, but by omitting to sign the recent legal form sent by SICC to ratepayers in the Oban Urban Drainage Area, their lack of response has resulted in Council having to assume they do not wish to make a capital contribution.

These nil-return responses have been used in calculating the shortfall which will be required to be serviced by a loan. This loan, calculated at \$125,000 will be paid off over a 25 year period. In real terms, an example of the kind of expense a ratepayer in the Oban Urban Drainage Area who has opted NOT to pay a capital contribution is in for, is as follows:

On a property with a land value of \$4,000 [average quarter acre section] the present County rate of 4.875 cents in the dollar would mean an annual rate bill of \$195. The Sewerage Rate of 5.850 cents in the dollar would mean a sewerage rate bill of \$243 per annum. This would in effect more than double the annual rates for that property owner, bringing it up to \$429.

It must also be remembered that this sewerage rate of \$234 per annum is for 25 years, giving a total of \$5,850 paid by that ratepayer at the end of the loan period. This figure is far in excess of the Capital Contribution of \$1905 being asked for.

Many people may not have realised the vast difference in these two figures. It is not too late to opt for the Capital Contribution, which will reduce the amount of loan money Council will have to borrow. Please note that once a Capital Contribution is made or promised, then:

**NO SEWERAGE RATE**  
will be levied on that property.

- Margaret Hopkins  
Deputy Chairperson SICC

## Report of Meeting 17 Aug 1988

### Wall of Remembrance

Council is proceeding with a low Wall of Remembrance at the Halfmoon Bay Cemetery. Plaques commemorating those who have died and been cremated or buried elsewhere may be affixed to this.

### By-election

Roger Brand who was Councillor and Chairman of the Works Committee for 18 months has left the Island to take up a employment with the Maniototo Electric Power Board. Nominations for his replacement have been called. A by-election is to be held in December if necessary.

### Passenger Levy - Local Bill

Council is to proceed with steps through the Dept of Internal Affairs, to have a Local Bill adopted in Parliament, enabling SICC to collect a passenger levy from all incoming travellers to the Island, both by sea and air. This levy of probably \$1.00 per person will be used to provide facilities on the Island such as public toilets, track maintenance in the Halfmoon Bay area, footpaths etc.

### Local Government Commission

SICC is to put in a submission to the Local Government Commission by the end of August, stating how Stewart Island sees itself being administered under the new Local Government reorganisation. SICC is to request that it be granted District Community Council status. A DCC has virtually the same powers as a Territorial Authority, except for a limited number of actions, such as making a rate or a by-law, raising loan finance and two or three other things. However, the Community Council would be a constituent member of a main authority, which would always endorse the recommendations made by the DCC in these respects, provided they were legally correct. A copy of the SICC submissions will be printed in the next issue of *SIN*.

### Track Maintenance

In the past SICC has received a grant for maintenance of local tracks under its jurisdiction. This money has been passed on to DOC who have undertaken the work. The actual cost of the work done has always far exceeded the money passed on by SICC. Because of financial restraints, DOC is now unable to carry out the work as it has done in the past. In a letter to Council, DOC has given an analysis of the work costs likely to be incurred on track maintenance over the next 2-3 years. This amount of \$16,091 will have to be met by rates or the proposed passenger levy.

### Memorial Plaque to Alan Wilson

On a suggestion from Peter Tait, Council resolved to have a plaque made in memory of Alan Wilson, who has kept many of the private generators on the Island in working order for many years. This will be affixed to the wall of the new Power House.



SICC has passed a resolution not to use 245-T on roadsides. In Oct last year 95 residents signed a petition asking for this. The Management Proposed by the Spray Action Group has been adopted as Council Policy for the control of noxious plants on the Island.

In March Graham Strickett, Head Field Officer for the South Island Noxious Plants Council visited the Island and stated there is no legal requirement to eradicate [get rid of completely] gorse and broom from our roadsides. He recommended a policy of containment - that is to stop gorse & broom spreading to new sites [usually ground that has been disturbed by humans]. To destroy isolated plants is the first priority - clumps of gorse and broom can be treated as any other roadside plant if they impede vision, they should be pruned back. We do not have to have a wholesale spraying campaign.

A Noxious Plants Officer from Invercargill visits Stewart Island regularly to check on our noxious plants. Many of you will remember Mr Crowthers and Miss Lobb [rumour has it that she sprayed in her bikini]. His job is to see that a policy of Noxious Plant Control is carried out. He is only allowed to spray on Council Roadsides if he has either: Served a "bluey" on our Council and is invoking Section 51[4] of the Noxious Plants Act, or has been invited by Council to do some spraying. Perhaps after all the ill-feeling generated last year, our Council may not feel very hospitable towards him. Council has a policy of Noxious Plants Control -

#### Goals of the Management Plan are:

- 1 To maintain roadsides in as natural a state as possible, for cosmetic reasons, with minimum visual damage to established or emerging flora.
- 2 To minimise erosion.
- 3 To reject extensive herbicide spraying. Limited use of biodegradable herbicides on individual plants.
- 4 To encourage natural regeneration of native species, using low impact acceleration where thought desirable [eg native planting].
- 5 Continued monitoring of spread/decline of existing infestations.

## The Obnoxious Issue Of Roadside Noxious Plant Control

### Suggested Program

- 1 Progressive maintenance of roadsides in order agreed by Council. Flat areas maintained by handwork: cutting, stump painting, knapsack spraying of specific plants.
- 2 Banks prone to erosion left alone, planting natives where practical.
- 3 Areas reverting with natives left to get on with it.
- 4 Heavy infestations - plant appropriate natives, keep clear if necessary. Avoid encouraging young gorse due to disturbing old plants, other than track and roadside maintenance.
- 5 Future community work days to follow supervised program.
- 6 The Spray Action Group would like to help Council implement this plan.

Could the people who showed concern in the past please help get the work done now? Native seedlings are needed too.

Those prepared to give a hand should phone:  
Jenny Hayden Ph: 391-568.



The situation with private land is different. Individual landowners may clear gorse and broom in whichever way they prefer.

- Jenny Hayden  
Spray Action Group



## Your Spring Garden

The August meeting was held at the home of Mrs Irene Dennis and arrangements were made for the Garden Circle's 20th birthday on 8 September. A lunch will be held at the South Sea Hotel. There will be no competitions in September.

### Competitions:

#### June Winners -

##### Conifer:

- 1st Mavis Tait  
2nd Iris Tait  
3rd Peggy Wilson

##### Flower:

- 1st Joanne Firestone  
2nd Mavis Tait  
3rd Iris Tait

##### Hostess Competition:

Won by Ann Walker

#### July Winners -

##### Yellow Flower:

- 1st Irene Dennis  
2nd Iris Tait  
3rd Tina Kershaw

##### Leek:

- 1st= Irene Dennis, Iris Tait  
2nd Mavis Tait  
3rd= Ellen Carstensen,  
Ann Walker.

#### August Winners -

##### Spring Flower:

- 1st Iris Tait  
2nd Irene Dennis  
3rd Dot Anderson

##### Hostess Competition:

won by Maureen Jones  
- Ann Walker

## Art & Craft Co-operative

Department of Internal Affairs Alternative Employment and Advisory Officers Victor MacGill and Wally Jeths, from Dunedin and Invercargill respectively, visited Stewart Island on 29 & 30 July to advise and assist members of the Stewart Island Arts & Crafts Co-operative Society.

Those present learned about working in groups co-operatively: the importance of becoming an Incorporated Society and possible sources of funding.

Most of the time was spent on developing guide-lines covering all aspects of the Society's activities. These will be used as a discussion paper so that members can prepare the Constitution required for Incorporation.

Both Victor and Wally took care to emphasise that their role was to advise and guide, to make members aware of choices and the need for flexibility. It became clear that more funds are available if any project provides full-time employment but members felt with the impact of the Picot Report to come, the group could be useful in bringing tutors to the Island.

The sessions concluded with everyone giving an evaluation. This showed that everyone had learned about tasks, processes, facilities, consensus, ground rules, brainstorming and rounds.

Thanks must go to Wally and Victor who braved the weather and intend to return. Also to the Principal of the Halfmoon Bay School, Barry Rhodes, who allowed the school to be used.

- Helen Bissland

### In the Flower Garden:

Sow pansy seed in shallow boxes. Plant Roses. Prune Fuchsias. Repot plants Gladioli corms may now be planted.

Now is the time to take chrysanthemum cuttings.

Half hardy annuals may be sown now. Nemesis, dahlia, Livingston daisy etc.

**Fashion Parade Review**  
by - Helen Bissland

## Bridespowns Revisited

A parade of bridal garments spanning a century of fashion was held at the home of Mr & Mrs Russell Squires on Tue 23 August. Determined work and a practice before the Halfmoon Bay School pupils resulted in a smooth presentation of over 24 wedding gowns and related clothing.

Alice Bissland and Cherie Johnson started the parade, modelling camisoles, pantaloons and petticoats made in cotton lawn with deep bands of broderie anglais trim. The garments were from Mrs T K Bragg nee Pasley's trousseaux. Mrs Bragg came to Stewart Island in 1906 as head teacher. She was married in 1910. Her daughter Neta Rawle loaned the garments for the parade, and they are to be presented to the Rakiura Museum.

A skirt worn by Miss Bina Peterson, daughter of Mr William Peterson, the first schoolteacher in Halfmoon Bay, was modelled by Phillipa Peacock. It was made of cream silk, frilled with a bustle. The Peterson family lived in Myrtle Cottage, now owned by the Rout family, who have presented the skirt to the Museum.

Joanne Scammell wore an embroidered tussore silk floor length skirt and jacket, sent to Mrs Margaret Bragg from Egypt in 1916 by her brother-in-law George "Nay" Bragg. A feature of the pale fawn outfit was the embroidery on the bodice and around the hemline.

Tracy Neave modelled the wedding gown of Mrs Maude Johnson who was married on 31 March 1937, at the Presbyterian Church in Kaikoura. Made from ivory silk velvet it was originally trimmed with orange blossom with shirring across the shoulders and on the lower panel of the skirt. The veil fell from the headband of orange blossom and

the bridesmaid and flower girl wore shell pink crepe de chine.

Displayed next was a magnificent magnolia satin wedding gown worn by Mrs Mary Harborow [Melanie Frew's mother] when she was married on 5 April 1939 at the Caversham Presbyterian Church, Dunedin. The gown was complemented by a delicately embroidered tulle veil. Mrs Harborow made her gown, as well as the lavender silk dresses for the bridesmaids and flower girl.

A gown of the sixties was that of Mrs Ann Field, now Mrs Rowley, a satin dress with flowing lines, delicately embroidered in the front with tiny pearls. The shoulder length veil fell from a circlet of pearl and diamante flowers, contrasting with brunette model Bridget Squires.

Tracy Neave showed the frock worn by Maureen Jones when married nearly 27 years ago. Maureen's frock of Skinner satin has deep pleats falling from the sides and around to the back, forming a train. Dior roses formed decoration under the bust and at the back waistline. The elbow length veil fell from a circlet of flowers studded with pearls. Maureen's bridesmaids and flower girl wore fuchsia pink delustrated satin.

Elaine and Bill Hamilton were married in St Andrew's Anglican Church Halfmoon Bay in February 1965. Karen Paterson wore Elaine's dress in Duchess- Dogona satin, appliqued with silver edged satin orchids, some petals detached to be three dimensional. The skirt had three gores in the front, falling into a full train at the back, with a large bow at the back waist. A coronet of pearls and diamante held an elbow length veil and Elaine carried a spray of white roses and a prayer book.

[More Next Issue]

## Diagnosis

DOC seems to be getting its share of publicity both locally and nationally, being used as a political football in some arenas. Down at ground level, ie here, it all adds up to a bit of belt tightening and carrying on with the jobs in hand.

Planning is under way for another kakapo catch and transfer trip during the summer, and for replacement accommodation to be flown to Benson Peak, after the original hut burnt down last month.

The fire completely destroyed the hut - only a pile of ashes and the concrete steps and fire place remained. Hard luck for the trappers who arrived the following afternoon, looking forward to a dry hut, a cup of tea and a bed after a tiring day. At least they managed to cook their evening meal in the still hot ashes - a small consolation.

Still on the subject of huts, we're likely to see hut charges coming into effect here soon. In the past trappers have enjoyed free accommodation, but as soon as a national system for the collection of hut fees can be set up, they will have to pay. As yet we have no idea of what the charge will be for huts on the Island.

Over the past few months several whales have been spotted around the coast and Foveaux Strait, particularly in the Pegasus area. We are interested in any reports of whale sightings around the Island and would like to hear from anyone who has seen a whale or, for that matter, any large or unusual marine mammal eg sea elephants or sea leopards, or tagged sea lions [animals are tagged at the base of the pectoral flippers with either red or yellow numbered discs - red if tagged on Campbell Island and yellow if tagged on the Auckland Islands].

On a lighter note, staff here recently discovered a hidden talent of Ron's.

Accepting a light hearted challenge to produce home made custard squares for smoko, he came up with the goods one afternoon. These were the Tindal version of the conventional custard squares - when the custard didn't set he froze them, which made an interesting variation, but one no less yummy. We think you need to keep up the practise Ron!

- Sandy King  
Department of Conservation

## Oban

### Presbyterian Church

On Sunday 21 August, Rev Blair Rodgers, the chaplain of Presbyterian Support Homes for the Aged in Invercargill gave a sermon on "Growing Old Gracefully", in the Presbyterian Church at Halfmoon Bay. Towards the end of the service Mrs Ethel Bragg presented a brass plaque on behalf of the family of Mr & Mrs Robert Hicks, in memory of their parents. Mr Hicks, who died recently, was a Session Clerk at the Church for 33 years.

The plaque was accepted by the Rev Rodgers on behalf of the church and he dedicated it to the memory of Mr Hicks and his wife Margaret.

Following this a shrub was planted in the Memorial Garden in front of the Sunday School. Mr George Hicks was asked by the Session to plant this shrub on behalf of the congregation, in appreciation of his parents long service to the Church.

- Lorraine Squires  
Session Clerk  
Oban Pres. Church

### Rakiura Cub Group

The Rakiura Cub Group would like to thank all those who bought Scout Caramel Mints. Your support is greatly appreciated. If you would like some more, we have a few left at \$2 a bag.

Phone: Erica Cleland 391-266  
or: Jayne Wilson 391-456

### Trust Bank Visit

Friday 7th October

Three representatives from Trust Bank Southland will be visiting the Island in October. They will be here to discuss all aspects of banking, including advice on deposits, lending and commercial banking. If you have any queries regarding your finances and would like an interview to discuss your banking options with trained and professional people, call into the Fire Brigade Social Room on Fri 7 Oct, 1988.



**ARTHUR BARNETT CREDIT CARD**  
0-1 2 3 4 5 6 7  
U.R. WELCOME

**DIC**

You can use your Arthur Barnett Credit Card at DIC. When shopping, simply say, "Charge it please". If you do not already have your Arthur Barnett credit card, apply for one today at DIC. Our friendly credit people will be happy to help you. You're welcome.

• INVERCARGILL 82-879  
DUNEDIN 740-089 • CHRISTCHURCH 799-140

Meetings take various forms, but usually include a Business Meeting. This serves the dual purpose of conducting the club's business and of providing practical training in correct meeting procedure.

President: Jo Riksem  
Vice-Pres - Membership: Loloma Slingsby  
Vice-Pres - Education: Helen Bissland  
Secretary: Iris Tait  
Treasurer: Anne Watson

## Computer Courses

It is planned to hold a series of computer courses starting around the third week of Term 3. These will be held either late afternoon or evening, depending on preferences. Those interested are to contact school, leaving your name, ability and times preferred. It is hoped to be able to "stream" people in order to make the courses more valuable and interesting. The first of the courses will be simply familiarisation with a chance to "tinker and play". For those more interested in advanced computer knowledge, we hope to get over an "expert" from the mainland, and hold a weekend course some time in November.

- Barry Rhodes

- Barry Rhodes

## "Are We Back to Zero Girls?"

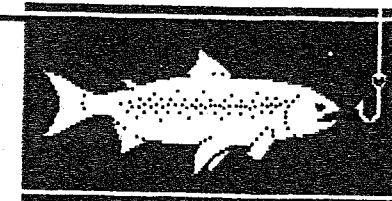

After we had been there for a couple of weeks, Tommy brought a radio, which helped to pass the time, except for the *Talkback Hour* from 10 to 11AM every day. We are convinced that people today only want to talk about dogs! We got so tired of it that one day Tommy had enough, marched over, and switched to the National Programme. We all thought this was worse [including Tommy] so ended up having our own Talkback programme, learning about each other and solving the problems of the world.

The thing we will always remember about Tommy is "Are we back to zero girls?". We'll also remember Gail with thanks for the hot homemade soup she sent us every day!

- Rose Hailes  
Arianne Brinkman  
Jo Ann Firestone

[Thanks girls - how about a few more notes from some other *Salmon Pens*?]

The  
**BUSINESS CENTRE**  
Southland Ltd



## The Shearwater Inn

Earthworks on the old tennis court site next to NZ Salmon's store and Oban Motors on Ayr St has progressed to the stage where Hamilton Builders can soon start work on *The Shearwater Inn*.

This is the name chosen for the Island's new development in visitor accommodation, which will have a total of 28 centrally heated bedrooms. These will have two, three or four beds, and the complex will cater for a maximum of 75 people.

The bedrooms are arranged back to back in two wings which face into a central paved courtyard with barbecue area. These wings will be slightly longer than in the architect's preliminary sketch shown here.

A large lounge with open fireplace, communal kitchen and TV Room link the two wings, while a flat for a resident

manager is being provided on the second floor. Exterior wall cladding will be Polite, with covering battens, which will give the building a slightly Tudor look. A dark coloured Coloursteel roof is designed to blend with the surrounding vegetation. The complex will cater for the budget conscious traveller who wants to cook for themselves, and for those prepared to dine out. Charges are planned to range from a basic rate of \$11/person for those providing their own sleeping bags and sharing rooms, to around \$20/person for a double room with bedding provided.

Even allowing for the weather and other delays inherent in any building project on the Island, it is expected to have work done to the stage where one wing will be in operation by Christmas. - Sam

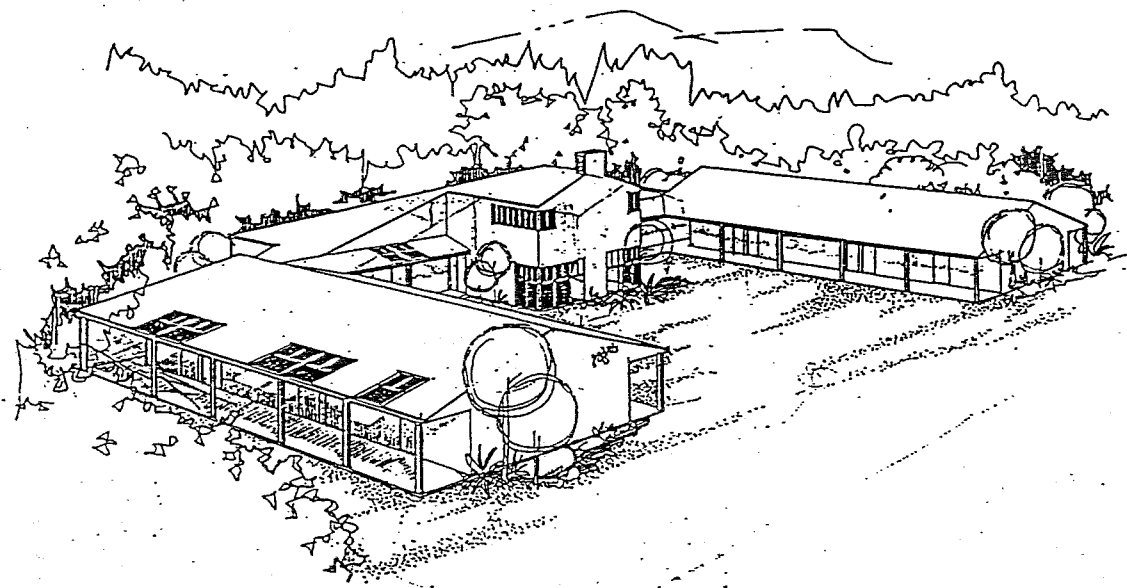

Architect's preliminary sketch as seen from Ayr St. Final plans are changed slightly. September is an appropriate time to commence construction, for this is the month the *Titi* or Sooty Shearwater will return to Stewart Island for the breeding season.

STOP  
PRESS



### Promotions for "Fox"

President of SI Promotion Assn, Lloyd Wilcox, was recently appointed to the Board of Southland Promotions Inc. This appointment is a singular honour for Lloyd, who has been very active in promoting SI AND the region for many years. His appointment to the Board will have the added advantage of keeping the Island in its present a high profile position as a tourist destination in the Southern Regions of New Zealand. - Sam

## Folksinger Debbie Gillanders

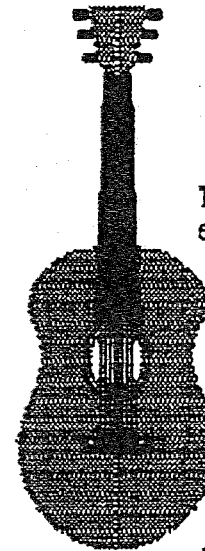

Thirty Islanders had an enjoyable couple of hours in the South Sea Lounge on Wed 31 August, listening to Debbie Gillanders, an English singer, currently teaching in Porirua. Most of her material was contemporary. Much of this modern folk music involves song of social comment, and songs of

English origin often include words of local dialect. It was therefore very pleasing to find Debbie giving us a background to the places and periods mentioned in the songs, and a translation of the more obscure words.

Several songs had a fishing flavour, and one or two hit quite close to home with their theme of declining fisheries and the social changes resulting from this.

Not all songs were serious though, and one about a brawny coal-mining foreman who was a part-time "drag queen" had the audience chortling delightedly as a whole series of complex relationships unfolded. Extra sex-role confusion was added having the song sung by a female.

A couple of Debbie's own songs were included in the program, and one about a 15 year old glue-sniffer she knows gave an insight into a city habit that fortunately doesn't hit close to our Island home as yet.

Debbie accompanied herself on guitar, with a very clean, controlled finger-picking style, ideally suited to the songs she sang. Doc Watson's *Deep River Blues* was played flawlessly, as were three instrumentals. To round off she sang a number of unaccompanied modern and traditional songs. An excellent evening for those who like slightly introspective live music.

- Sam

## Ross's Rumbblings

Over the last month several small items have been reported to me as being stolen. The complainants have all said that someone has probably "borrowed" the article and forgotten to return it.

This "borrowing" appears to be a custom on the Island, and while it works well provided the article is returned, borrowing becomes theft if you decide to keep the item.

While on the subject of theft - ELECTRIX, that mighty gang of men who have given us power, have been targeted of late, and approximately 20 lengths of Australian

hardwood, 2m X 100mm X 75mm have been taken from behind the County Office. The lengths of timber are valued at \$65.00 each, are imported and Electrix tell me they can't get any more for three months.

This may be funny for some people, But for Mrs Carstensen of Hicks Rd, it means another three months in the cold. I like to think of the Island as basically honest, so if you know where Electrix might find 20 lengths of crossarm timber, please tell them or me - Mrs Carstensen would appreciate it!

- Ross Dymock

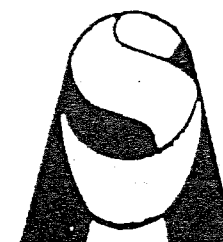

## Sheet Metalcraft Ltd

33 Bowman St INVERCARGILL Phone 86-315  
[A/H Trevor Manson Ph: 358-042]

Specialists in: \* TIG & MIG welding \* General sheet metal work  
\* Stainless steel & aluminium fabrication



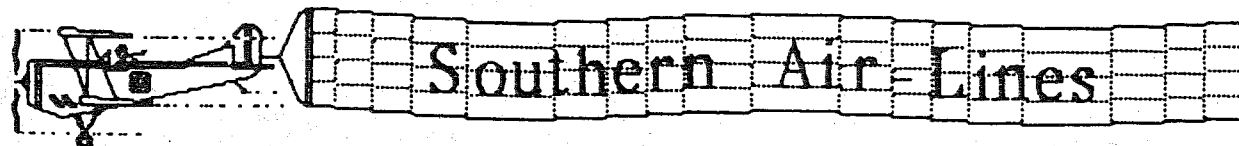

Things are really flying at Southern Air again now, so lets think Summer is just around the corner - as so is Xmas. The weather hasn't been too bad lately, with just the odd foggy day. When you live south of Chch you get used to it - we're a hearty bunch down here.

Our most recent addition to the fleet is an Aerospatiale Squirrel helicopter, along with its Pilot Richard Mills.

Firstly, the Pilot hails from Otautau, so is another good Southland chap, ex-Southland Boys High School. He's been flying helicopters for 10 years, with experience in the UK, Scotland and South Africa as well as of course in New Zealand. This has been mainly crop spraying and general charter work.

About five years ago Richard formed his own company called South Coast Helicopters, flying a Bell Jet Ranger. Unfortunately this helicopter was destroyed by a fire in the

hanger at the same time as the merger between South Coast Helicopters and Southern Air was about to take place.

The Squirrel is a six passenger helicopter which can lift about 750 kilo and cruises at 120 knots. As well as for general duties on the Island and round Southland, we are using it to collect live crayfish from boats round the Island to deliver them to the processing shed. These are packed live, then flown to Japan - a new export market for Stewart Island and New Zealand.

In recent times we have flown the Collegiate football and netball teams, plus a few other groups and musicians.

Don't forget people, now it's Spring, you can fly at 5PM during the week, so you can have a longer day in town.

Next month we shall briefly explain the working of the helicopter. So we shall keep our wing flapping.

Over and Out  
- Flying Phil

Well folks, we are pleased to say that *Big-E* [*Endeavour*] has completed her annual survey with flying colours, or one could say "brighter colour". The slight change of green certainly stands out.

Since her survey she has been back plying the Straits again, with salmon food, vehicles and general cargo.

Although the weather hasn't really been too kind for the tourists, there still seem to be a few hardy souls who thrive on a lot of "adventure" in their lives, particularly when good old Foveaux really lives up to its renowned reputation.

Please note that we are still on the winter timetable, which means we sail from Half-moon Bay at 13.30 [1.30PM for the land-lubbers] Mon, Wed & Friday.

It would be appreciated if anything to be sent over to Bluff could be clearly named.

That's all we've got from Charter Service Chatter for this month.

- Lyn Voigt

## Charter Service Chatter

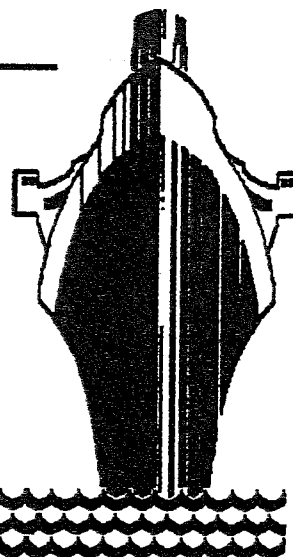

### Report

E Following the Open Tech pilot, work is  
A in progress to develop a permanent  
P extended teleconference network in  
Southland. So the prospects look good  
for the Island! The out come of the Picot  
Report indicates that REAP will be  
"reviewed" in 1990.

Alison Broad



## From the Sin-Bin

Dear Sir

It is with great concern that I hear of all the Stewart Island Playcentre money being spent on sending mothers to town for courses all the time. Not a week goes by without there being one of them away to a meeting or course.

Is this the modern way of spending money which the people of this community have donated in good faith, expecting that it will be spent at the Playcentre for the benefit of the children?

I am not against parent education, and realise there are some who may gain a lot from this, but I do think it would be better if the Playcentre got advisers to come to the Island and take in-session courses here at our Playcentre so that all the mothers will gain, not just the few who would be better off spending the time at home with their children, judging by the disgusting behaviour of a lot of pre-schoolers these days.

As one who has always supported the local Playcentre at their stalls and fairs, I will not be giving any more money until I see the practise of sending mothers away to town discontinued. It is acceptable that the Supervisor or whoever is in charge of organising the Playcentre Programme attend these courses, but not a whole lot who will be finished with Playcentre within a year, when their children go to school.

I think it is a sad reflection on society these days that mothers spend less time with their children and are too busy pursuing their own interests. There are too many unruly, bad-mannered and violent children in this world today, who will be tomorrow's delinquents. Modern mothers may hold with freedom of expression, but it is sad for the children that no one will like them any better for it.

- Grannie

[Dear Grannie - Newspapers usually only accept nom-de-plumes if they are accompanied by the writers name, and we prefer to do the same, so we can direct replies back. However, this time we passed your letter on to Playcentre for their reply which you'll find on the next page - SIN]

Dear Sir,

I would like to congratulate the people responsible for the "noiseless engines" at the power station [MOW I believe] I walk past Mrs Carstensen's corner quite often, and cannot believe how quiet they are. In fact, the first time I thought the engines must have stopped. Congratulations on a job well done.

- Elaine Hamilton

[Thanks for the letter Elaine, it's the first one we've had concerning the power scheme - SIN]

## Forest & Bird 1989 CALENDARS

These lovely calendars depict  
New Zealand Kauri Forests.  
They make a wonderful gift  
for overseas friends or  
for those with a love of nature.

**\$11.00**

From: Iris Tait or  
Margaret Hopkins

\*\*\*\*\* Basin Award #14

## Gerry Field

After a SI Lions Director's meeting on Tue 30 Aug, Gerry [accompanied by a President who shall remain nameless for a change] went and started the generator at the RSA Hall, ready for the club's evening meeting. When fined by Taitwister Reubin Morris for wasting fuel, Gerry hadn't noticed that the lights had been going all evening - without a murmur from the switched-off [and disconnected] generator.

Nominated: Mick Gibb  
Seconded: Reuben Morris



Dear  
"Grannie"

The Stewart Island Playcentre operates under Group Supervision, which means all parents are responsible for planning and running sessions. Each parent needs to take the challenge and learn how to amuse children, extend their motor, social, intellectual and imagination skills. To enable us to do this we need to send parents away on courses to learn these skills. It is not practical for tutors to attend each centre in Southland, to give in-session courses, as there are 31 centres.

Money to send mothers to courses does not come from the local community, and we are not always sending parents away. We have applied for, and received grants from COGS, Donald Bickley Trust and the ILT. Community raised money has been spent on upgrading equipment, new books, aquaplay system, cupboards, hoops, balls, paint and paper. The Fun Fair is our annual local fund raising venture.

Southland PC Assn provides creches for children of mothers attending courses in town. Other Island PC families are usually happy to look after children while mothers are away so our children are not neglected while we are away. So far this year, five courses have been attended by only 12 mothers.

Early Childhood Education has recently been recognised as being the most important learning stage of life. Patterns are set in this age group that will define how an individual copes with stressful situations, shares resources and toys, tackles challenges, copes at school and much more. We are proud to be part of this at Stewart Island PC and we work hard to provide an environment to facilitate this kind of experience for our pre-schoolers. Some of us give our time and enthusiasm voluntarily to the Southland PC Assn, which is responsible for the 30 other PCs, in the hope that those mothers too will feel enthusiastic and caring towards the welfare of their young ones.

Colleen Dawson is the Southland Playcentre Assn President and she attends two monthly

meetings in Invercargill. Most of her work is done at home, with hours on the phone.

Jenny Haydon is the Southland PC Assn's Education Committee Convener. This committee plans parent education courses throughout Southland. Jenny attends two meetings a month and sometimes tutor courses run by the Association. Denise Schofield is also on the Education Committee and attends one meeting a month. These trips are paid for by the Southland PC Assn and costs our Island Playcentre nothing.

Many women choose to continue with Playcentre after their children attend school, either at the local centre or at Association level, and they provide a valuable resource within the community. We call on our local PC "oldies" to run workshops and have recently had an excellent music and movement workshop from Kathy Walker. Gail Learmonth has promised us some time too. Perhaps "Grannie" also has some skills she'd like to share with us?

We only have the children for five hours a week and the problems some have originate from the home environment. No amount of training will enable anyone to completely change these children. Playcentre can only give parents skills to effectively raise their children. Stewart Island Playcentre hopes to host a positive discipline course later this year: this will benefit parents of school age children as well. Playcentre would again extend a welcome to anyone to attend the Playcentre sessions to see the kind of activities shared with our children.

Playcentre for Term 3 will be Tue and Thu from 9:15am till 11:45am. There is a Toddler session on Wed morning.

Perhaps we could extend an invitation to "Grannie" to attend one of our sessions to see for herself what we achieve at our local PC, and she can see that we take the business of raising our children very seriously.

- Jenny Haydon  
Denise Schofield  
Stewart Island Playcentre

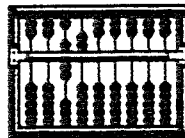
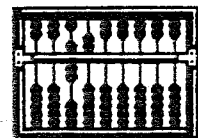

## TODD Real Estate

Enquiries welcomed  
Please phone (021) 391-144  
Diane & Philip Smith  
"Tammata"  
PO Box 104 Halfmoon Bay  
STEWART ISLAND

### Latest Listings

Five magnificent building sites being offered as one 1.1238ha block [2.75acres] - \$98,000

Tidy 3-brm cottage on sunny elevated site. Handy to school, shops etc. - \$49,000

Boatshed at Golden Bay - \$4,500

Prime 1140sq.m Site at Thule overlooking Paterson Inlet Has uninhabitable dwelling - \$17,000

At Ringaringa, 3-brm home with magnificent sea view. Spacious kitchen, separate lounge, garage, 810 sq.m section opp. Golf Course. Handy to good boat anchorage - \$55,000

3376 sq.m [3/4 acre] right on waterfront at Deep Bay. Offering elevated building site with superb view into Paterson Inlet - \$16,000

At the top of Whipp Place, 1118 sq.m, elevated and sunny, offering grand view over Halfmoon Bay - \$12,000

Magnificent building site with panoramic view over HMB & also into Paterson Inlet. Quite unique. Gently elevated, 1716 sq.m - \$27,500

Overlooking Horseshoe Bay, superb 2.0411 ha [5 acres] All day sun, beach frontage. Subdivisible. Together with delightful home: low maintenance, 2 db.bdrms, large lounge, all newly decorated. Multifuel range, also gas range. Sun deck. Large basement, could be lined for extra living or downstairs flat. Perm. water.

Wood lot - \$110,000

### Also Presently Available for Sale

\* 4 holiday/permanent homes. Priced between \$40,000 & \$56,000

\* 2 sections - Golden Bay Rd & Main Rd

\* 3 large blocks of land

\* Commercial property. Halfmoon Bay's perfect tourist accommodation site.

### Photocopying

Enlarging & Reducing  
Black & White  
Choice of Six Colours

Robertson's  
Place

45 Bowmont St  
Phone: 83-352

### Rawleigh's Products

- new - new - new -

Calcium Capsules  
[with Vitamin D]

### Ladies

This is essential  
to prevent osteoporosis  
[calcium loss in bones]  
in your old age

If you wish to avoid  
brittle bones  
in your golden years

Contact

Your Rawleigh Agent  
Erica Cleland - ph: 391-266

### Events Calendar

#### SEPTEMBER

Saturday 10th

Power House Opening  
10AM - SEPS Advisors [Hall]  
1.30PM - Official Opening  
3PM - Afternoon Tea [Hall]  
4.30PM - Hangi [Hall]

Thu 15/Fri 16

Dentist [Clinic] Rex Forrest

#### OCTOBER

Friday 7th

Trust Bank Southland [OVFB]

### REAP Courses

LATE OCTOBER

Seminar/Workshop on Personal  
Development - Topics include:  
Assertiveness,  
Communication & listening skills  
Personal Power - etc

LATE NOVEMBER

Explosives Demonstration Course  
[Watch Noticeboard]

## Stewart Island Charter Service

Box 24 - Halfmoon Bay Ph: [021]  
378-376 - Bluff

### Winter Timetable

#### Monday/Wednesday/Friday

Bluff	Stewart Island	Bluff
Dep	Arr	Dep
9:00	11:00am	1:30
		3:45am

**Ticket** - from 1hr before sailing

**Board** - from 15min before sailing

## Southern Air

Invercargill Airport  
Box 860 Ph: [021] 89-129  
INVERCARGILL

### Spring Timetable

#### Monday to Friday

In'gill	Stewart Island	In'gill
Dep	Arr	Dep
9:00	9:20am	9:30
		9:50am
1:00	1:20pm	1:30
		1:50pm
5:00	5:20pm	5:30
		5:50pm

#### Saturday/Sunday

10:00	10:20am	10:30	10:50am
1:00	1:20pm	1:30	1:50pm
4:00	4:30pm	4:30	4:50pm

#### Reporting Times

In'gill Airport - 30min before flight  
S Is Travel - 40min before flight

## Business House Hours

### Anchor Merchants

General Store - Papers  
Meat/Milk/Bread  
9:00am-5:30pm Mon-Fri  
10:00am-Noon Sat/Sun

### Co-op Chandlery

Basic Clothes/Meat  
10am-11:45am Mon-Sat  
1:30-pm Mon/Wed/Fri

### Co-op Fish Shed

Fresh & Frozen Fish  
8:00am-6:00pm Daily

### Stewart Island Travel

Sthn Air Agent - Taxis  
Souvenirs - Tearooms  
Hire Vehicle - Petrol  
8:00am-6:00pm Mon-Fri  
9:30am-5:00pm Sat/Sun

### Ferndale Caravans

Shop open on demand  
[at reasonable hours]  
for Food Supplies

### Rakiura Riders

Hire Motor Scooters  
10am-5pm most days  
[Ph: 391-011 if closed]

### South Sea Hotel

#### Public Bar:

11am-10pm Mon-Thu  
11am-11pm Fri/Sat

**Lunch:** Noon-1:00pm

**Dinner:** 6:00-7:00pm  
[Casuals book by 4:30pm]

### Korner Krafts

Wed/Sat  
10:30am-2:30pm

### Post Office

9:00am-1:00pm Mon-Fri  
2:00pm-5:00pm Mon-Fri

### Rakiura Museum

11:00am-2:00pm  
Mon/Wed/Fri

Other Times Phone

Tina Kershaw 391-458  
Margaret Hopkins 391-126  
Nancy Schofield 391-340  
Wally Fisher 391-099

### Stewart Is Library

2:00pm-3:00pm Wed  
11:00am-Noon Fri

### DOC Info Centre

8:00am-4:30pm Mon/Fri  
[A/H & W/E see notice  
on door for Duty  
Officer's Phone No.]

### DISTRICT NURSE CLINIC

10:30-Noon Mon-Fri  
[Phone: 391-098]

### POLICE

[Phone: 391-020]

### EMERGENCIES

Dial "111"



## Stewart Island News

[Registered Publication]

To:

Chris Dillon  
117 Metzger St  
Invercargill.

P.O.Box 65 Halfmoon Bay STEWART ISLAND New Zealand